

# Quick Build Program Pilot



# What is a Quick Build?

---

- Temporary/Semi-permanent
- Quick to install
- Lower-cost





# Why?

- Safety Benefits
- Test New Designs
- Fill Network Gaps
- Build Trust



Pilot Ideas – Protected Bike Facilities

# Pilot Idea – Super Blocks

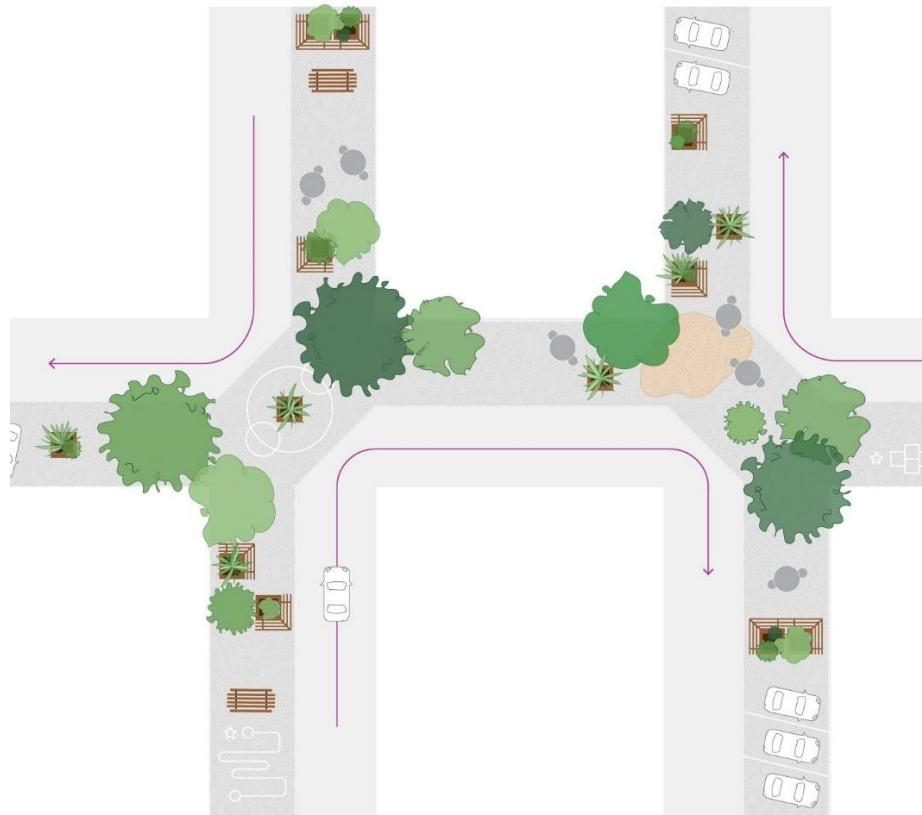
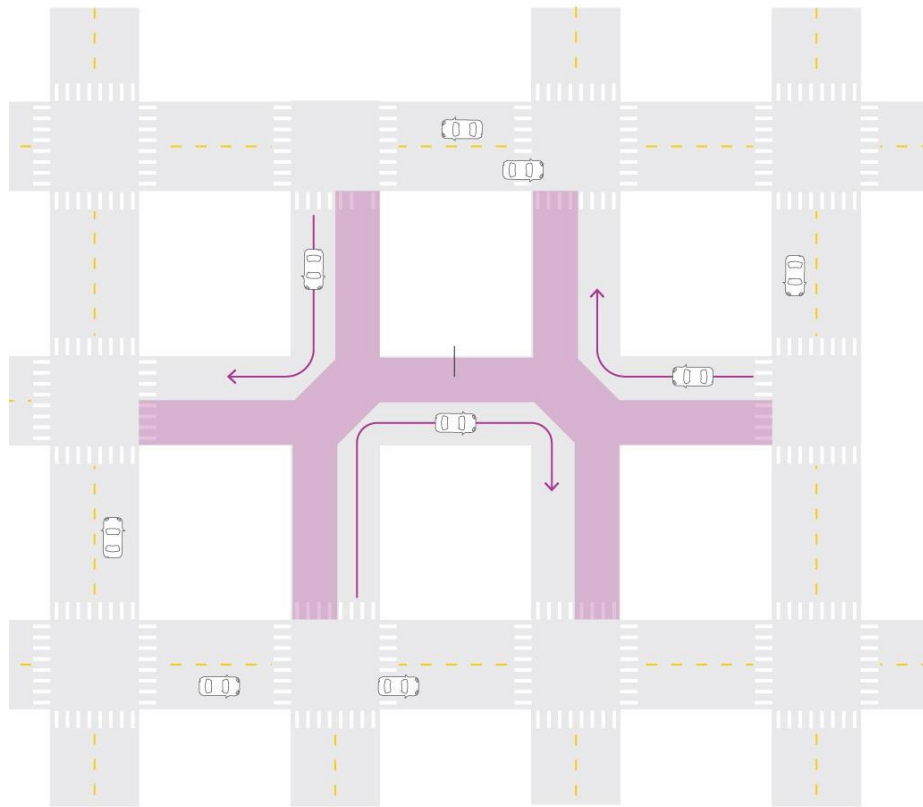



Pilot Idea – Curb Extensions

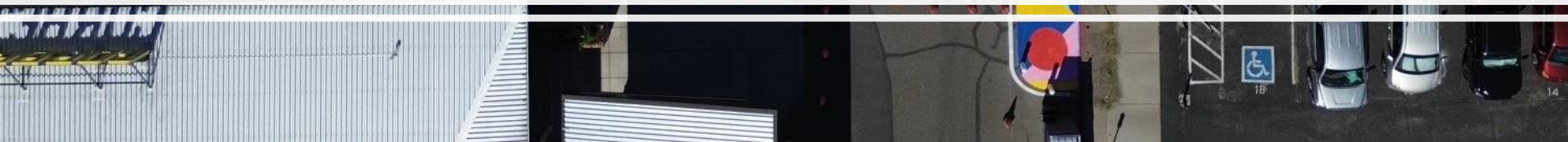



Pilot Idea - Roundabout

# Quick Build Process

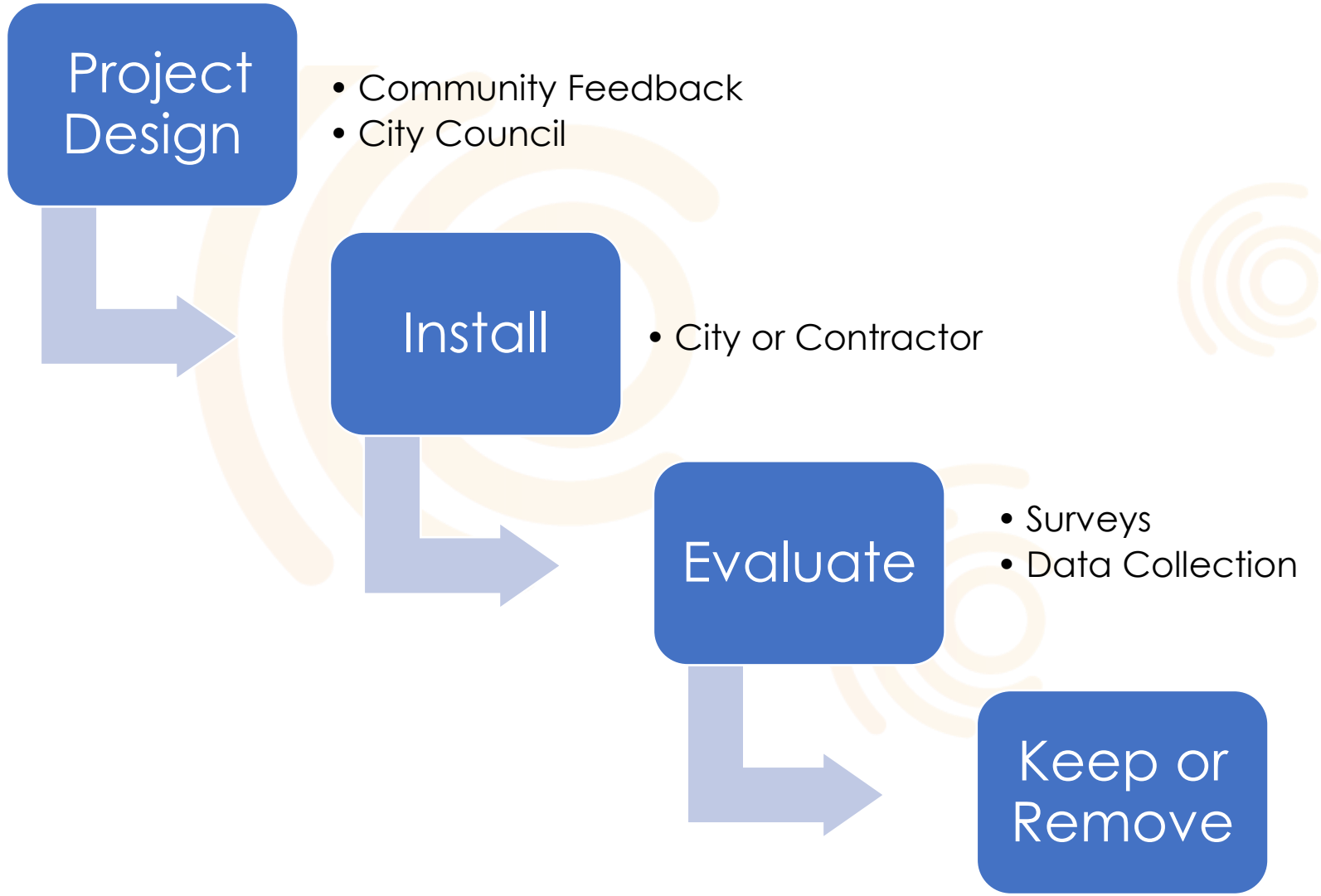



# Program Timeline

Fall 2024  
**Program  
Development**

Spring 2025  
**Pilot Project  
Design**

Winter  
2024/25  
**TAMC Board**

Fall 2025-2028  
**Pilot  
Installation &  
Evaluation**

# Discussion

- Questions?
- Thoughts?